

The Old Way

OEM style is difficult to use.

Time consuming installation.

- Metal-on-metal impact.
- Temporary nut for backing wastes time.
- Inconsistent torque on the nut.
- Costly parts.

Difficult removal.

- The nut gets stuck.
- Mantles are burned.
- Heads are damaged



Damage to the head from burning.

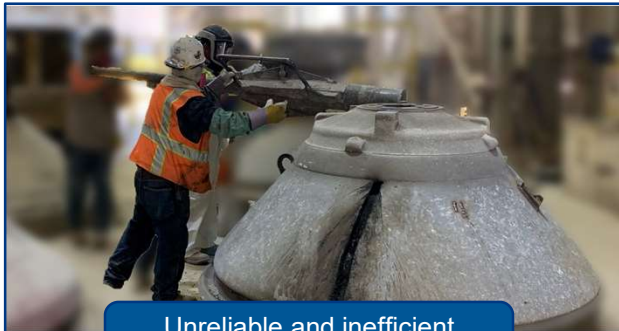

Unreliable and inefficient metal-on-metal impact.

TRI STAR DESIGN & MANUFACTURING
WE HELP YOU FIND SOLUTIONS

Safer – Faster – Smarter
The right tooling for the right job.

– CUSTOM DESIGNS –

We specialize in finding custom solutions to your unique problems. We help find answers.

– MANUFACTURING –

Our fabricators, machinists, and foundries will ensure your products are built and delivered on time and within budget.

– ENGINEERING SERVICES –

We can provide full service engineering support, both as an on-site engineer or an off-site service provider!

– OUR PRODUCTS –

With a focus on safety, durability, and ease of use; our custom products are designed with your site in mind.

WE HAVE EXPERIENCE IN YOUR INDUSTRY!

Mining
Oil and Gas
Power Generation
Processing & Manufacturing
Construction
Marine
many more...

TRI STAR
DESIGN & MANUFACTURING, INC.

4833 E. Southern Ave. Phone 480.345.1699
Mesa, Arizona 85206 USA Fax 480.345.9859
www.tristardesign.com sales@tristardesign.com

TRI STAR
DESIGN & MANUFACTURING, INC.

Mantle Clamp™

Updated design for the
Symons® 7-ft. SH

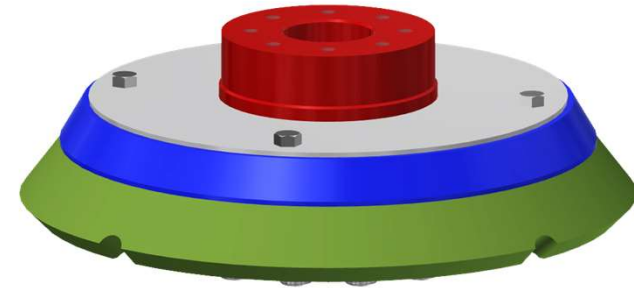

No more hammering or burning!

Our patented Mantle Clamp eliminates hazards and improves installation.

The right tool for the right job!

Clamp Plate and Bolts ensure consistent installation every time.

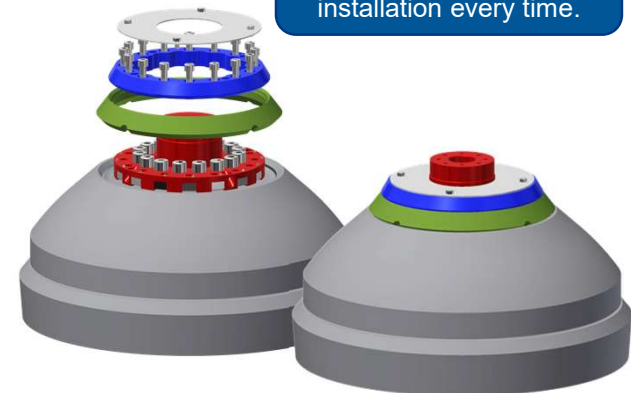

DESIGNING, MANUFACTURING, & ENGINEERING
CUSTOM DESIGNED TOOLING SINCE 1991

Introducing a better way!
Safer – Faster – Smarter

TRI STAR
DESIGN & MANUFACTURING, INC.

Mantle Clamp™
Updated design for the
Symons® 7-ft. SH

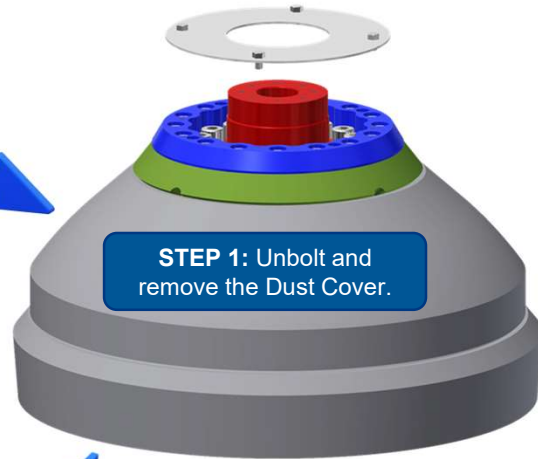

STEP 1: Unbolt and remove the Dust Cover.

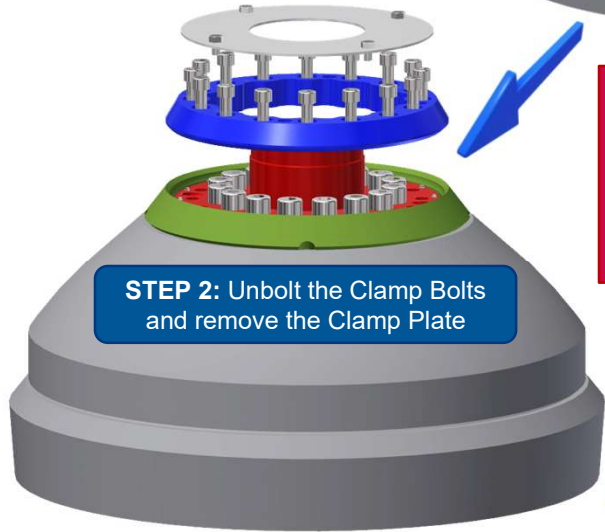

STEP 2: Unbolt the Clamp Bolts and remove the Clamp Plate

It really is that simple!
– No burning the mantle –
– No hammering the nut –
– No temporary pour nut –
All parts are loosened with wrenches and torque wrenches.

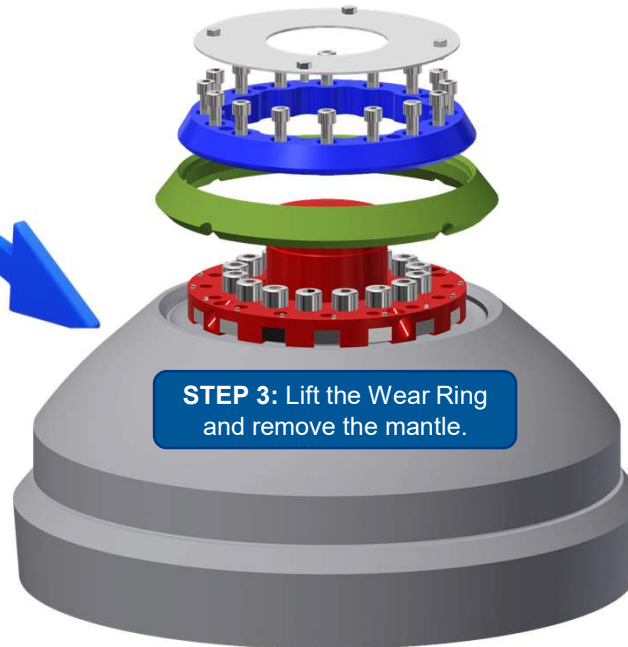

STEP 3: Lift the Wear Ring and remove the mantle.

Backing material can be poured directly into the Clamp Plate before the Dust Cover is installed. No temporary nuts or reassembly is required!



Eliminate spun liners!
High strength Clamp Bolts provide consistent downward pressure on the liner. Eliminate slippage!

Wear Ring sight holes ensure full backing material installation.

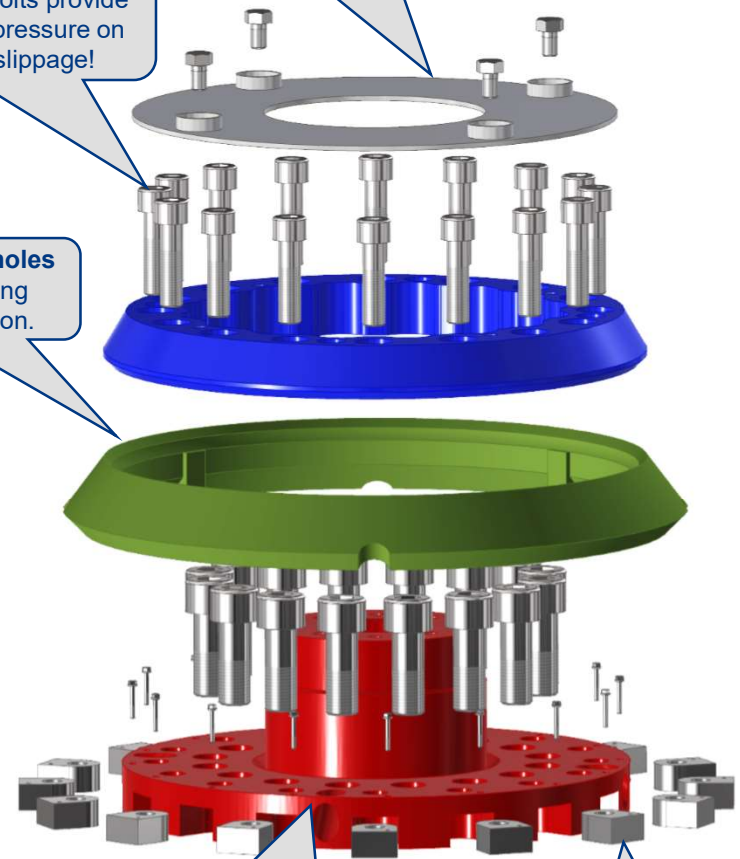

Locking Collar Assembly is installed once and should outlast the head.

No taps or dies required!
Damaged threads are easily replaced.

This patent pending **Mantle Clamp™** design eliminates many installation hazards, decreases work time, and improves hold down pressure. Installation of liners no longer requires hammering of antiquated oversized nuts to ensure proper seating. Our Clamp Plate and Clamp Bolts ensure proper torque every time. The Clamp Plate allows for backing material to be poured directly behind the nut. No need for temporary pour nuts.
A smarter way to re-line the Mantle.

Go online to see more or request a quote.
tristardesign.com/SH7-MCA

